

APPLICATION

Bench mounting

DETAILS

Waterflow around 13l/min
at 3 Bars pressure

Test pressure: 9 Bars/air

Max working pressure: 10 Bars

SURFACE PROTECTION

Epoxy powder coating
RAL 7035

MATERIALS

Brass

Handle in PP

HEADWORK SEALING

EPDM temperature
working range: 0-70°

CERAMIC temperature
working range: 0-70°

CONNECTION TAP

Male thread G1/2"

STANDARD AND NORMS

EN13792:2000

DIN12898

DIN12918

ISO228/1

OPTIONS

Joystick handle
11080.2MDSJ

Ceramic headwork 90°
11080.2MDSC

With chemical nickel
plating 17 microns inside
11080.2MDSNK

Spout:

150 - 200 - 230

250 - 300 - 350 mm

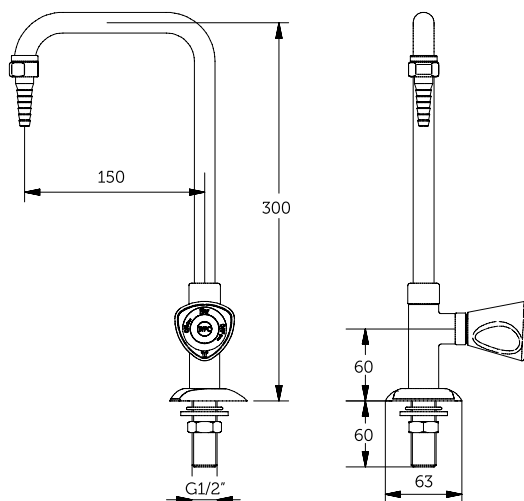

APPLICATION

Bench mounting

DETAILS

Waterflow around 13l/min
at 3 Bars pressure

Test pressure: 9 Bars/air

Max working pressure: 10 Bars

SURFACE PROTECTION

Epoxy powder coating
RAL 7035

MATERIALS

Brass

Handle in PP

HEADWORK SEALING

EPDM temperature
working range: 0-70°

CERAMIC temperature
working range: 0-70°

CONNECTION TAP

Male thread G1/2"

STANDARD AND NORMS

EN13792:2000

DIN12898

DIN12918

ISO228/1

OPTIONS

Joystick handle 11080.2MDSLJ

Ceramic headwork 90°
11080.2MDSL

With chemical nickel
plating 17 microns inside
11080.2MDSLNK

Spout:

150 - 200 - 230

250 - 300 - 350 mm

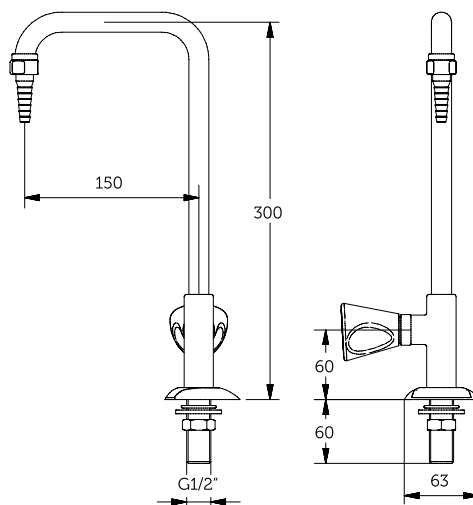
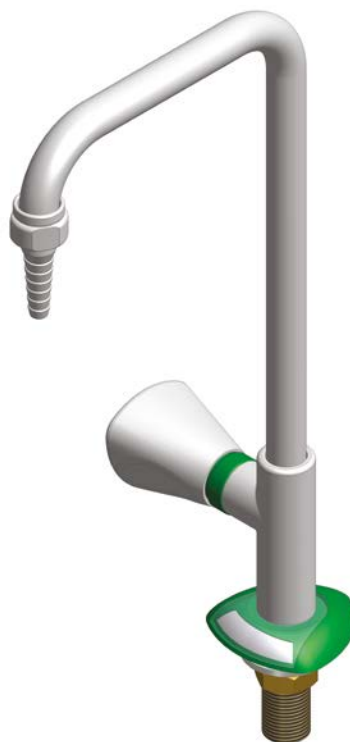

APPLICATION

Bench mounting

DETAILS

Waterflow around 13l/min
at 3 Bars pressure

Test pressure: 9 Bars/air

Max working pressure: 10 Bars

SURFACE PROTECTION

Epoxy powder coating
RAL 7035

MATERIALS

Brass

Handle in PP

HEADWORK SEALING

EPDM temperature
working range: 0-70°

CERAMIC temperature
working range: 0-70°

CONNECTION TAP

Male thread G1/2"

STANDARD AND NORMS

EN13792:2000

DIN12898

DIN12918

ISO228/1

OPTIONS

Joystick handle 11080.2MDSRJ

Ceramic headwork 90°
11080.2MDRC

With chemical nickel
plating 17 microns inside
11080.2MDSRKN

Spout:

150 - 200 - 230

250 - 300 - 350 mm

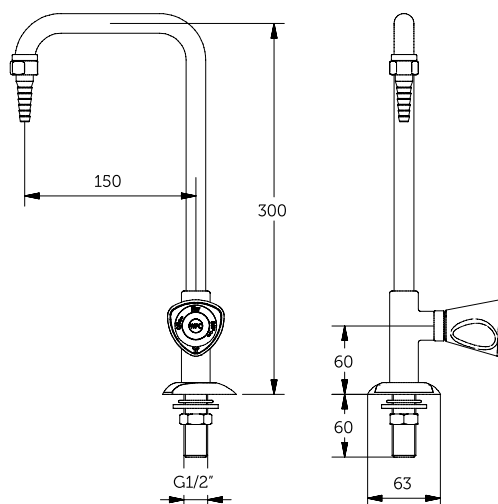
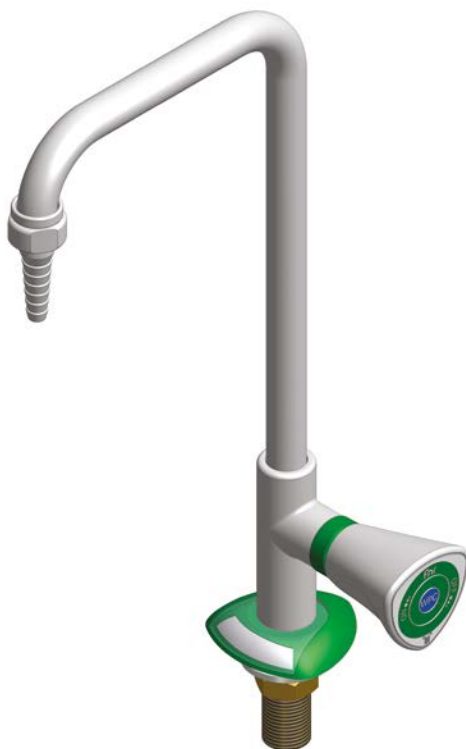

APPLICATION

Bench mounting

DETAILS

Waterflow around 13l/min
at 3 Bars pressure

Test pressure: 9 Bars/air

Max working pressure: 10 Bars

SURFACE PROTECTION

Epoxy powder coating
RAL 7035

MATERIALS

Brass

Handle in PP

HEADWORK SEALING

EPDM temperature
working range: 0-70°

CERAMIC temperature
working range: 0-70°

CONNECTION TAP

Male thread G1/2"

STANDARD AND NORMS

EN13792:2000

DIN12898

DIN12918

ISO228/1

OPTIONS

Joystick handle 11080.2MDSSJ

Ceramic headwork 90°
11080.2MDSSC

With chemical nickel
plating 17microns inside
11080.2MDSSNK

Spout:

150 - 200 - 230

250 - 300 - 350 mm

